

Rugby High School

Etiquette whilst in school during the Covid-19 crisis

Issue Date: 2/9/2020

General Principles:

1. Observe 2m social distancing at all times when moving around the school
2. You may wear a mask when moving around the school
3. When arriving at school go to your allotted hand washing station
4. Queue in line and wait to be called to the washing station by staff
5. Follow the **one way** system at all times
6. Use hand sanitiser when you enter your classroom
7. As far as possible exit all ground floor classrooms through fire doors to outside
8. Stay in your year group bubble for lunch and break.
9. Year 12 may NOT leave the site at lunch time
10. You will be directed to wash your hands before you leave at the end of the day

If you experience any of these Covid-19 symptoms :

High Temperature, Dry Cough, Difficulty Breathing, Loss of Smell/Taste

You must tell an adult immediately – You must NOT attend school

Ground Floor

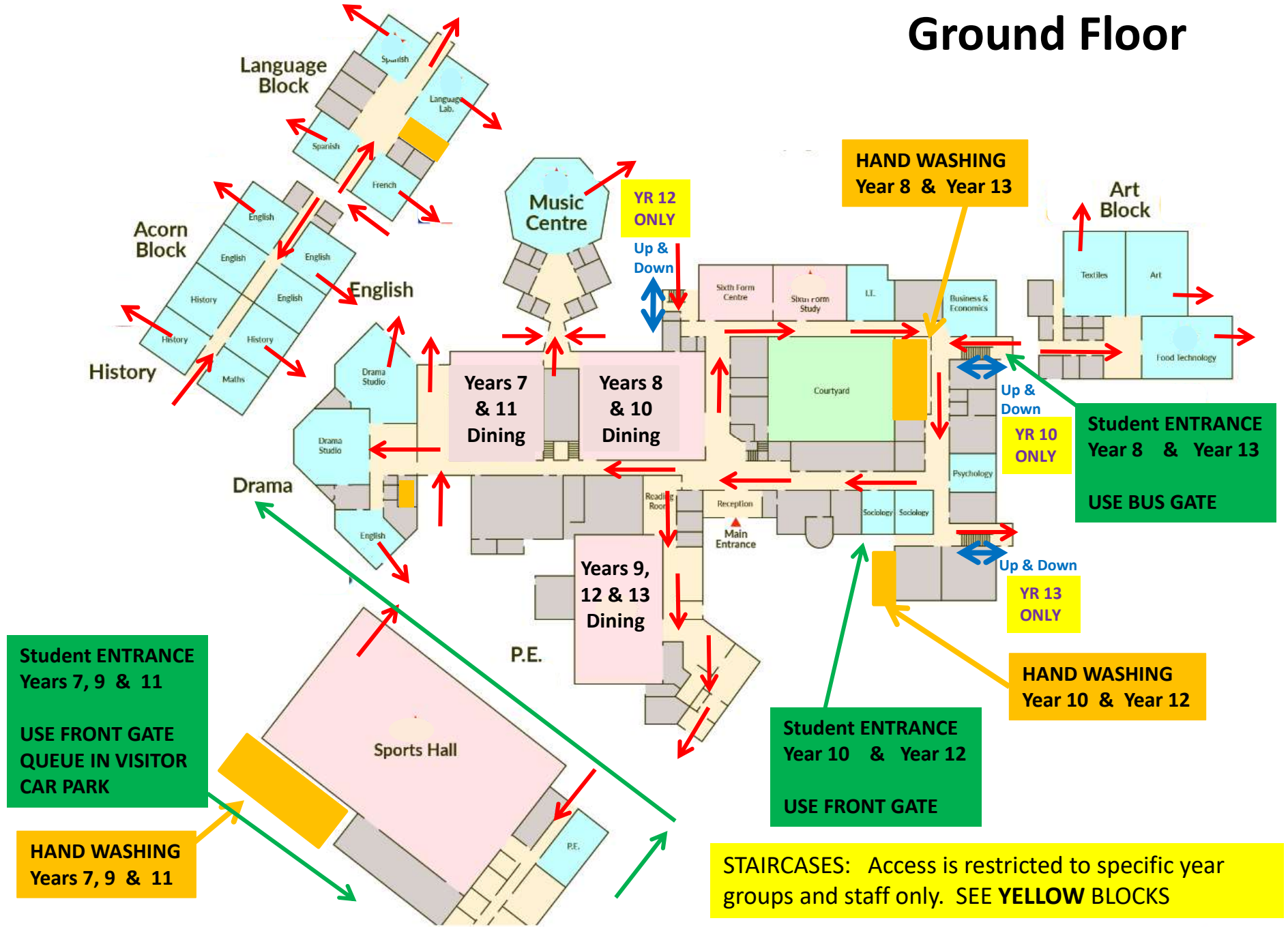

HAND WASHING
Year 8 & Year 13

YR 12 ONLY
Up & Down

Student ENTRANCE
Year 8 & Year 13
USE BUS GATE

YR 10 ONLY
Up & Down

YR 13 ONLY
Up & Down

HAND WASHING
Year 10 & Year 12

Student ENTRANCE
Year 10 & Year 12
USE FRONT GATE

Student ENTRANCE
Years 7, 9 & 11
USE FRONT GATE
QUEUE IN VISITOR CAR PARK

HAND WASHING
Years 7, 9 & 11

STAIRCASES: Access is restricted to specific year groups and staff only. SEE **YELLOW BLOCKS**

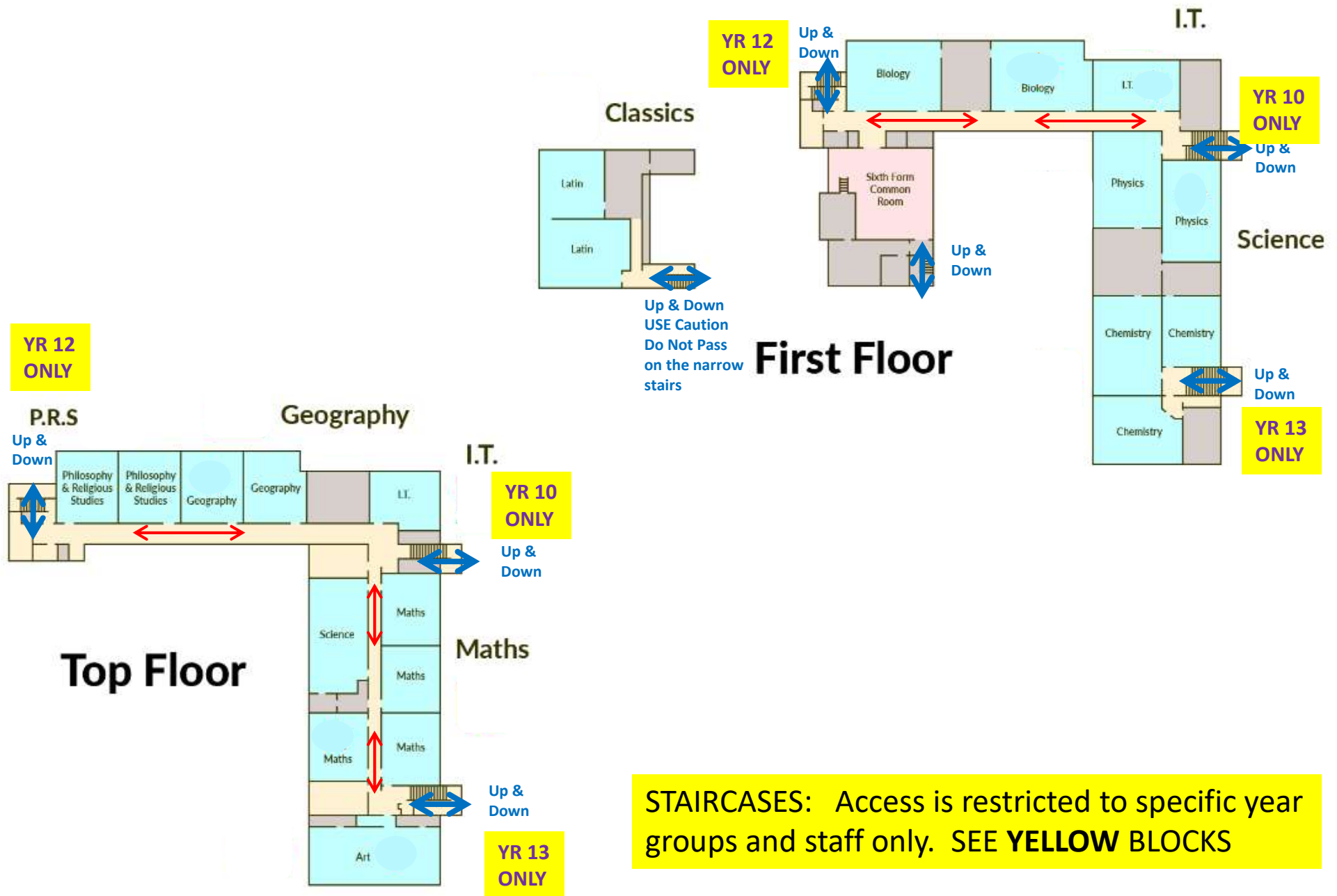

STAIRCASES: Access is restricted to specific year groups and staff only. SEE **YELLOW** BLOCKS